

8 x Triangular Gussets

Gusset dimensions:

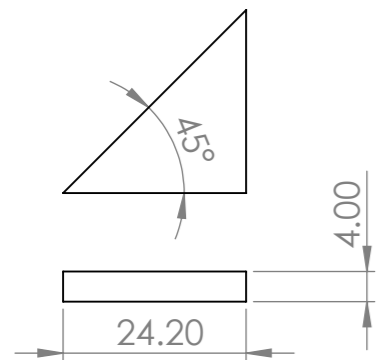

Dimensions of part (4):

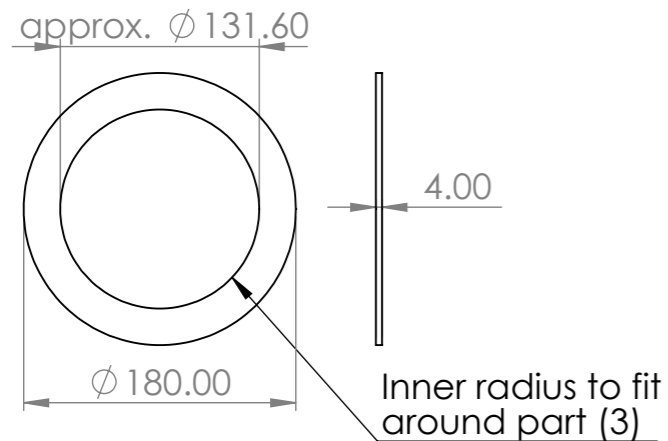

Turn out radius to match copper tube (1)

Turn out radius to match steel tube (3)

Braze or silver solder

Weld

Weld

SECTION D-D

Part descriptions:

- (1) - Copper combustion chamber
- (2) - Nozzle
- (3) - Steel tube that slides over copper
- (4) - Annulus that connects (3) to (5)
- (5) - Retainer ring
- (8) - Outlet ring

NOTE:
The coolant inlet and outlet holes (i.e. the large holes on parts (5) and (8)) must be 180 degrees out of phase.

UNLESS OTHERWISE SPECIFIED: DIMENSIONS ARE IN MILLIMETERS SURFACE FINISH: TOLERANCES: LINEAR: ANGULAR:			FINISH:	DEBURR AND BREAK SHARP EDGES	DO NOT SCALE DRAWING	REVISION
NAME	SIGNATURE	DATE	TITLE:			
DRAWN			DWG NO.			
CHK'D			COMBUSTION_CHAMBER_ASSEM			
APPV'D			SCALE:1:2			
MFG			SHEET 1 OF 1			
Q.A			MATERIAL:			
			WEIGHT:			